

**Model HPQFF3**  
**High Pressure Externally Pressurized**  
**Expansion Compensator**  
**For Riser Application**

HOUSING CUT AWAY TO SHOW BELLOWS

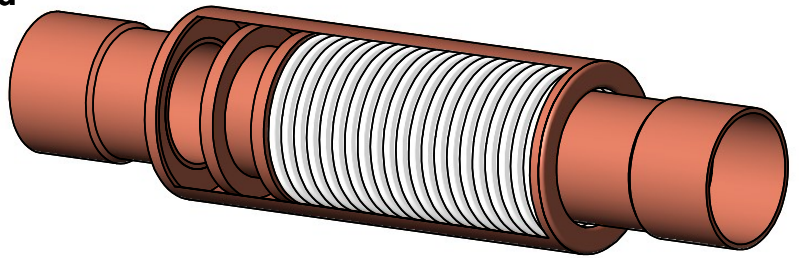

**DESIGN DATA**

TEMPERATURE : 400° F (204°C)\*  
 PRESSURE : 150 PSI (1034 kPa)\*  
 TEST PRESSURE : 225 PSI (1551 kPa)  
 AXIAL COMPRESSION : 3" (80mm)  
 AXIAL EXTENSION : 1/2" (13mm)

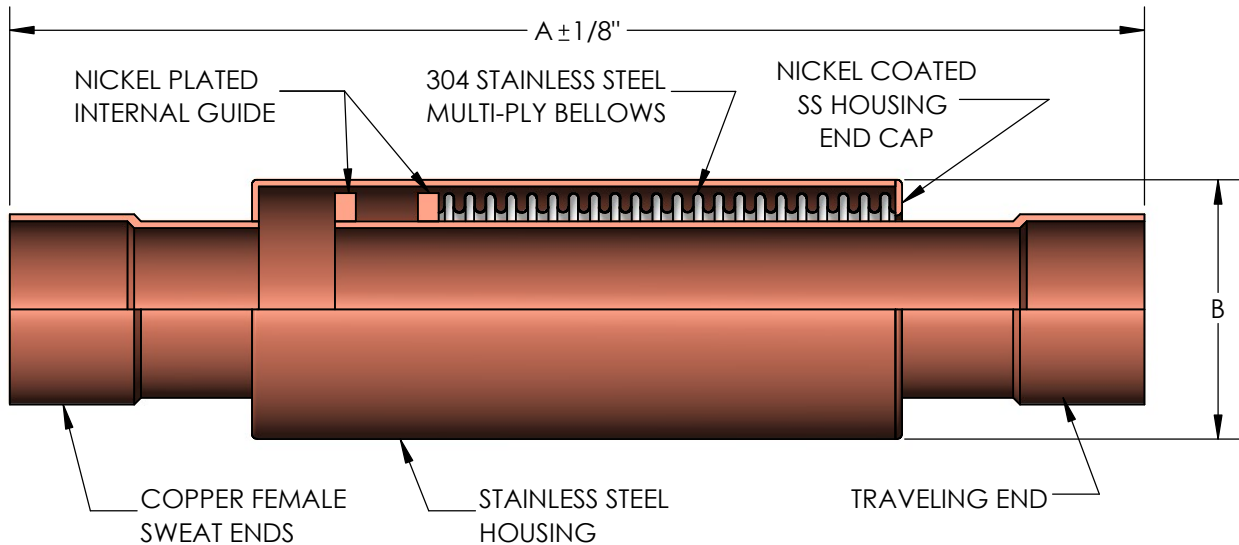

This expansion joint is designed for use in riser applications and axial movement only. Consult Metraflex for guiding and anchoring of pipe in riser application. For horizontal runs, the guiding and anchoring recommendations of the Expansion Joint Manufacturers Association is to be followed.

QTY	PART NUMBER	PIPE SIZE		A	B	EFFECTIVE AREA (in <sup>2</sup> )	SPRING RATE (lb/in)	WEIGHT	NOTES
		INCH	MM						
	HPQFF30075	3/4"	20	22"	2.25	1.1	58	1	
	HPQFF30100	1"	25	22"	2.25	1.7	63	1-1/2	
	HPQFF30125	1-1/4"	32	22"	2.60	2.4	54	2	
	HPQFF30150	1-1/2"	40	23"	3.00	3.2	52	3	
	HPQFF30200	2"	50	23"	3.50	5.1	118	4	
	HPQFF30250	2-1/2"	65	24-1/2"	4.25	7.6	110	5	
	HPQFF30300	3"	80	25-3/8"	5.00	10.6	175	6	

**NSF 372 - LEAD FREE**

The wetted surface of this product contacted by consumable water contains less than one quarter of one percent (0.25%) of lead by weight. Material complies with state codes and standards, where applicable, requiring reduced lead content. Not suitable for potable water systems due to materials of construction.

**MATERIALS:**

BELLOWS MULTI-PLY S/S T304  
 OTHER PARTS COPPER & SS

CUSTOMER: \_\_\_\_\_

PROJECT: \_\_\_\_\_

ENGINEER: \_\_\_\_\_

**Metraflex**  
*for pipes in motion*  
 2323 W. HUBBARD ST.  
 CHICAGO, IL 60612  
 TEL: 312-738-3800  
 FAX: 312-738-0415  
 WWW.METRAFLEX.COM

**MODEL HPQFF3**  
 HIGH PRESSURE EXPANSION COMPENSATOR

DRAWN BY: <b>DEVINR</b>	DATE: <b>11/30/2023</b>
APPROVED:	DATE:
SCALE: N/A	DRAWING NUMBER: <b>HPQFF3</b>