

**MODEL HPG2  
HIGH PRESSURE  
EXTERNALLY PRESSURIZED  
EXPANSION COMPENSATOR**

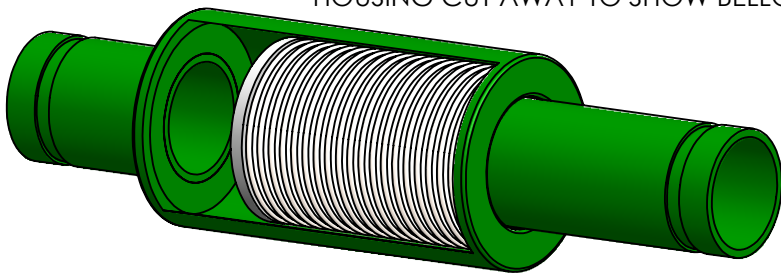

**DESIGN DATA**

CONFORMS TO MIL-DTL-17813H  
 OPERATING TEMPERATURE DEPENDENT UPON GASKET AND/OR SEAL SELECTION  
 MAXIMUM WORKING PRESSURE: 175 PSI (1206 kPa)  
 MAXIMUM TEST PRESSURE: 250 PSI (1809 kPa) @ 70°F  
 AXIAL COMPRESSION: 2" (50mm)  
 AXIAL EXTENSION: 1/2" (13mm)

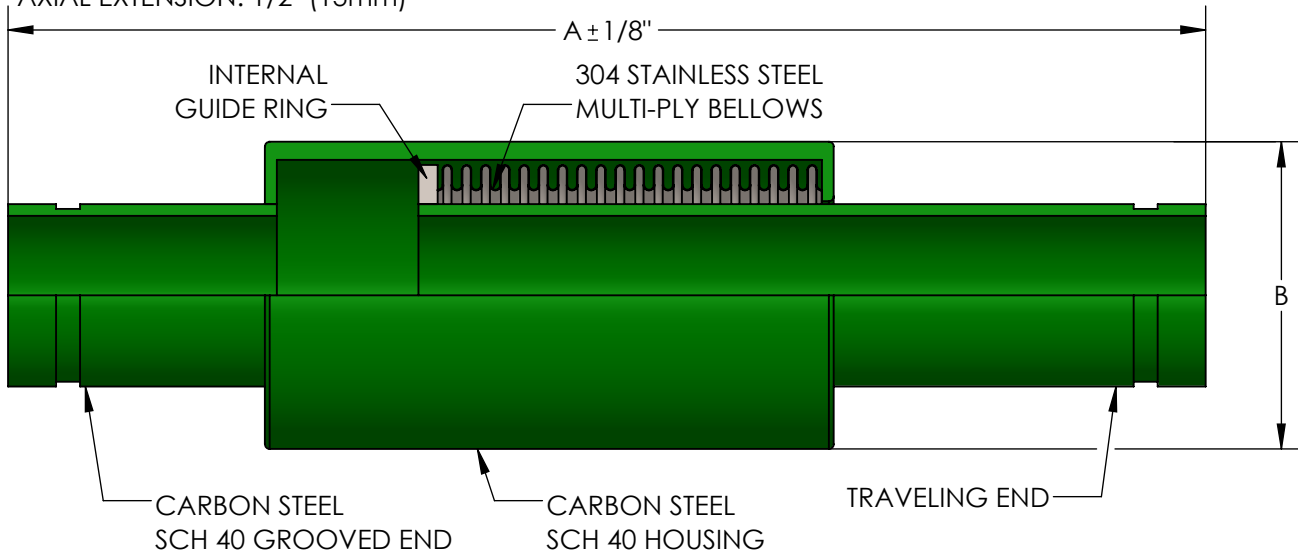

THIS EXPANSION JOINT IS DESIGNED FOR AXIAL MOVEMENT ONLY. PIPE MUST BE PROPERLY GUIDED AND ANCHORED PER THE RECOMMENDATIONS OF THE EXPANSION JOINT MANUFACTURERS ASSOCIATION.

| QTY | PART NUMBER | PIPE SIZE |     | A       | B      | EFFECTIVE AREA (in <sup>2</sup> ) | SPRING RATE (lb/in) | WEIGHT | PROJECT INFORMATION |
|-----|-------------|-----------|-----|---------|--------|-----------------------------------|---------------------|--------|---------------------|
|     |             | INCH      | MM  |         |        |                                   |                     |        |                     |
|     | HPG20075    | 3/4"      | 20  | 12-3/4" | 3"     | 1.5                               | 81                  | 3      |                     |
|     | HPG20100    | 1"        | 25  | 13-1/4" | 3"     | 2.1                               | 88                  | 4      |                     |
|     | HPG20125    | 1-1/4"    | 32  | 13-1/4" | 3"     | 3.3                               | 75                  | 5      |                     |
|     | HPG20150    | 1-1/2"    | 38  | 14-5/8" | 3-1/2" | 4.3                               | 121                 | 7      |                     |
|     | HPG20200    | 2"        | 50  | 14-5/8" | 4"     | 6.3                               | 143                 | 10     |                     |
|     | HPG20250    | 2-1/2"    | 65  | 16"     | 5"     | 8.8                               | 187                 | 14     |                     |
|     | HPG20300    | 3"        | 80  | 16"     | 5-1/2" | 13.1                              | 230                 | 18     |                     |
|     | HPG20400    | 4"        | 100 | 16-3/8" | 6-5/8" | 20.8                              | 484                 | 25     |                     |

**NSF 372 - LEAD FREE**

The wetted surface of this product contacted by consumable water contains less than one quarter of one percent (0.25%) of lead by weight. Material complies with state codes and standards, where applicable, requiring reduced lead content. Not suitable for potable water systems due to materials of construction.

CUSTOMER: \_\_\_\_\_

PROJECT: \_\_\_\_\_

ENGINEER: \_\_\_\_\_

|  |   |   |
|--|---|---|
| 2  | Edit temperature-pressure rating. Add compliance          | 01/07/2021  |
| REV. 1   | Edit B dimension to 3" on lines 1 and 2. DATE: 08/27/2019 |   |
|  |   | 2323 W. HUBBARD ST.<br>CHICAGO, IL 60612<br>TEL: 312-738-3800<br>FAX: 312-738-0415<br>WWW.METRAFLEX.COM |
| <b>MODEL HPG2</b><br>HIGH PRESSURE EXPANSION COMPENSATOR |   |   |
| DRAWN BY: <b>DKISH</b>                                   |   | DATE: <b>9/3/2015</b>   |
| APPROVED: <b>JC</b>                                      |   | DATE: <b>9/3/2015</b>   |
| SCALE: <b>N/A</b>  | DRAWING NUMBER: <b>HPG2</b>                               |   |